



PVS

(Pumpmor Vertical Solids) Pump

PVS Pump

PVS (Pump Vertical Solids) which is also well known as the **Haulage King**, has a proven track record for reliability. The models come out in two sizes 50mm and a 76mm.

- Vertical Pump
- Available in two sizes - 50 mm and 76 mm
- Hardened chrome iron for an increased wear life
- Can achieve up to 87 meter head at speeds of 2950 rpm

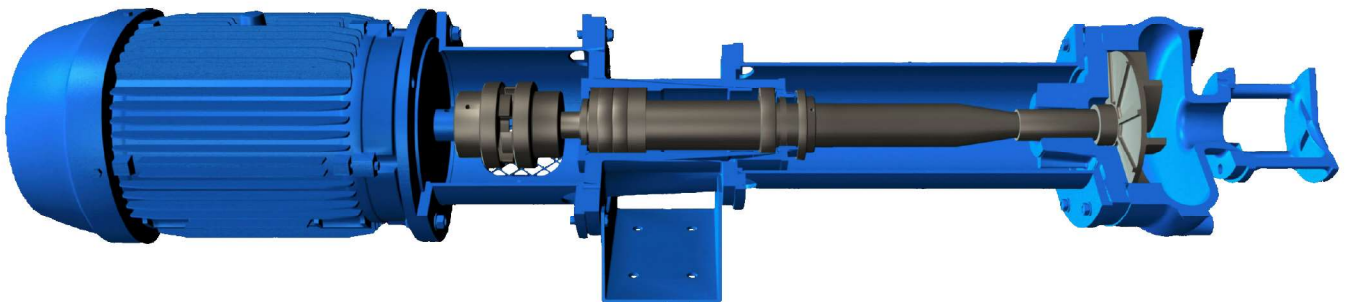

PVS Cross sectional view

PVS Pump

The PVS range originates from the HS range, the wet end is constructed from a hardened chrome iron 27% (650BHN) for an increased wear life.

The Hydro solids configured pumps are all designed with the same recessed impeller that gives a lower efficiency than comparable size pumps with the impeller in the flow path.

Due to the recessed impeller, large abrasive material can enter the suction inlet and be expelled through the pump discharge without damaging the impeller.

The PVS range can achieve up to 87 meter head at speeds of 2950 rpm.

The vertical range are available in different shaft lengths that range from 0.9m, 1.1m, 1.5m, 1.8m, and

the pumps are manufactured in one spindle length of 0.7m and one motor drive. Solids up to 76mm and S.G's to 1.5 can be handled.

The hydro solid is a vortex pump designed to pump sludge and slurries containing large abrasive solids, trapped air, and fibrous materials. The PVS range is manufactured for both light and heavy duties.

Ideally suited to many difficult mining applications as well as waste treatment, paper and pulp, food processing foundries and steel mills, agriculture and manufacturing industries.

Vortex Action

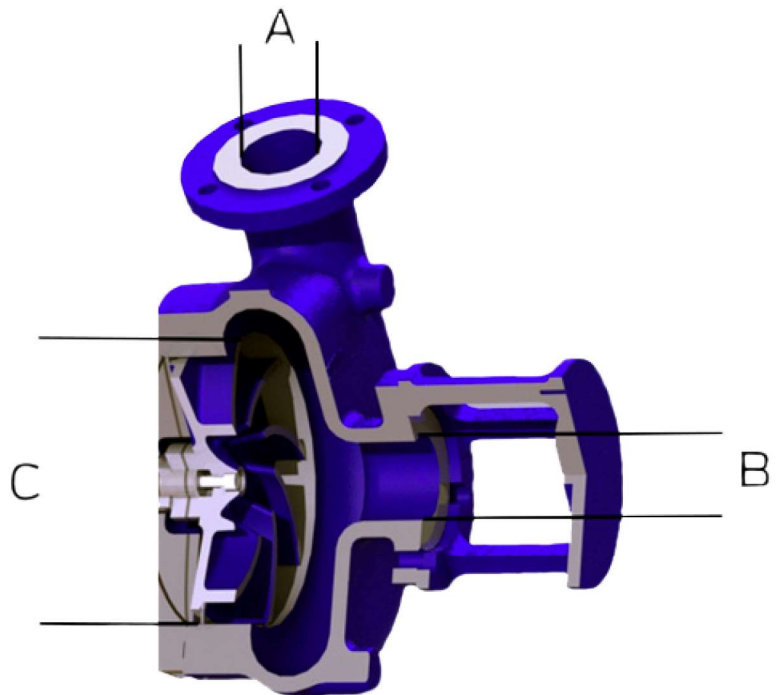
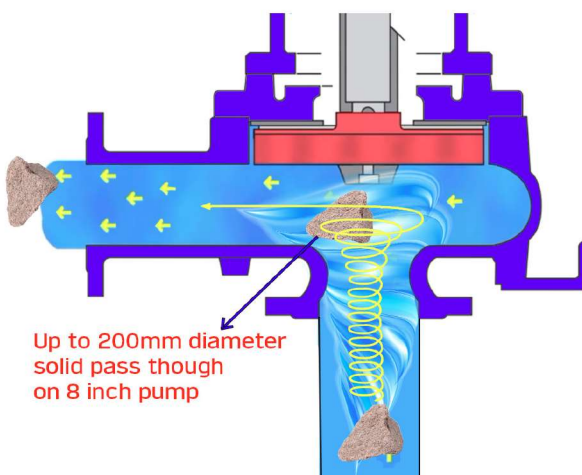

DISCHARGE	SUCTION	IMPELLER
(A)	(B)	(C)
50 mm	50 mm	203 mm
76 mm	76 mm	256 mm

PVS Pump

Features

- The recessed impeller will allow any sphere and virtually any solid that enters the suction inlet to pass through the casing discharge.
- Cantilever Shaft with no submerged bearings.
- Stuffing Box cover minimises blow back of media around the shaft sleeve without actual sealing contact.
- Rugged one piece casing is designed to facilitate the flow of all types of solids and fibrous materials.
- High Strength Pipe Column maintains alignment between the bearing frame and casing.
- Bearing Frame is a solid cast one piece with 30mm wall thickness that insures precise alignment between bearings.
- Construction - CR27% (650BHN) material as standard for increased wear life. Other materials include: Cast Iron, SS316, CD4MCU

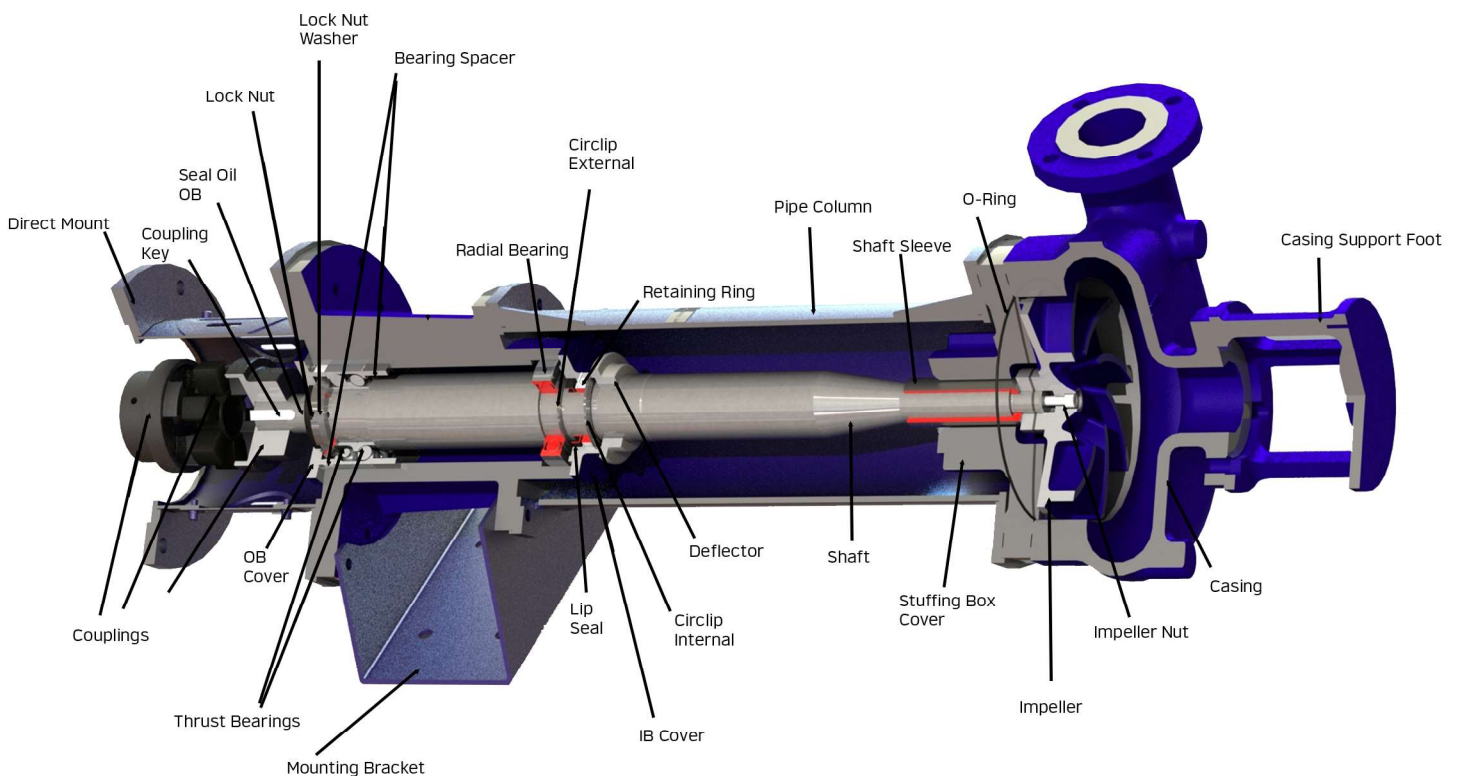

2 POLE

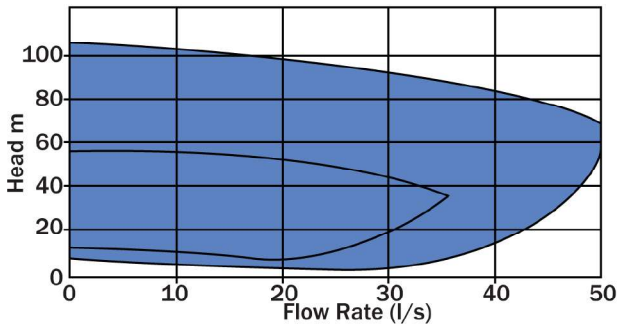

4 POLE

HYDRAULIC COVERAGE

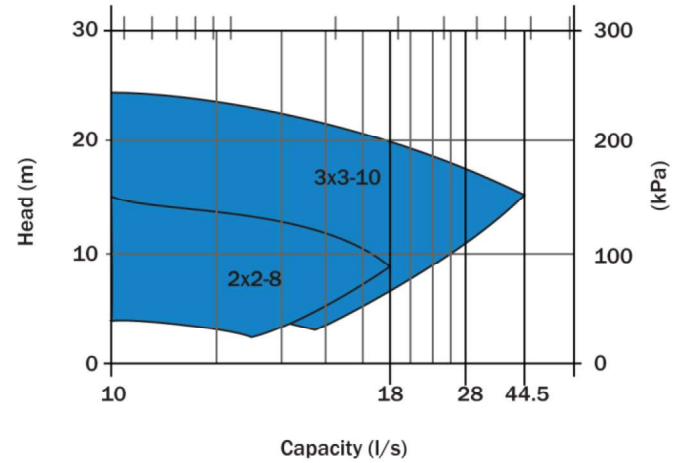

PVS Pump range

MODEL	MAXIMUM HEAD (M)	MAXIMUM CAPACITY (L/S)	SUCTION FLANGE (mm)	DISCHARGE FLANGE (mm)	IMPELLER (mm)	MOTOR (kW)	MOTOR (rpm)	PIPELINE (mm)
PVS 65	12	12	50 MM	50	203	7.5	1450	75
PVS 65	45	12	50	50	203	22	2950	75
PVS 80	20	20	75	75	254	15	1450	100
PVS 80	57	20	75	75	213	37	2950	100
PVS 80	87	20	75	75	254	55	2950	100

Becker Mining South Africa (Pty) Ltd

4 Clarke Street North
Alrode, Johannesburg
South Africa

Tel +27 11 617 6300
Fax +27 11 908 5806

info@za.becker-mining.com
www.becker-mining.com